

LIFTING EYE BOLTS

A38

อายโบลท์ (รู้ง) DIN

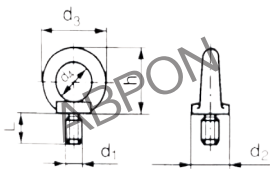
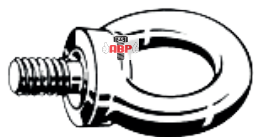

STANDARD	DIN580
MATERIAL	STEEL
COATING	YELLOW
CODE	AEB
UP DATE	11-12-2006

Size (d1)	h	b	d2	d3	d4	k	จ	Unit Price
1/4 - 20	36	13	36	20	20	8	100	
5/16 - 18	36	13	36	20	20	8	100	
3/8 - 16	45	17	45	25	25	10	50	
1/2 - 12	53	20.5	54	30	30	12	25	
5/8 - 11	62	27	63	35	35	14	25	
3/4 - 10	71	30	72	40	40	16	25	
1" - 8	90	36	90	50	50	20	10	
1.1/4 - 7	109	45	108	65	60	24	5	
1.1/2 - 6	128	54	126	75	70	28	5	
1.3/4 - 5	168	68	166	100	90	38	5	
2" - 4.5	168	68	166	100	90	38	5	
2.1/2 - 4	208	90	206	120	110	48	5	
M6 - 1.0	36	13	36	20	20	8	100	
M8 - 1.25	36	13	36	20	20	8	100	
M10 - 1.5	45	17	45	25	25	10	50	
M12 - 1.75	53	20.5	54	30	30	12	25	
M14 - 2.0	62	27	63	35	35	14	25	
M16 - 2.0	62	27	63	35	35	14	25	
M20 - 2.5	71	30	72	40	40	16	25	
M22 - 2.5	90	36	90	50	50	20	10	
M24 - 3.0	90	36	90	50	50	20	10	
M30 - 3.5	109	45	108	65	60	24	5	
M36 - 4.0	128	54	126	75	70	28	5	
M42 - 4.5	147	63	144	85	80	32	5	
M48 - 5.0	168	68	166	100	90	38	5	
M64 - 6.0	208	90	206	120	110	48	5	

LIFTING EYE NUTS

อายนัท (รู้ง) DIN

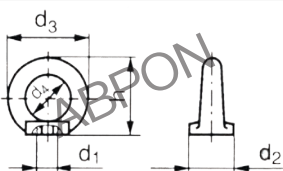

STANDARD	DIN582
MATERIAL	STEEL
COATING	YELLOW
CODE	BEN
UPDATE	11-12-2006

Size (d1)	h	d2	d3	d4	k	จ	Unit Price
1/4 - 20	36	36	20	20	6	100	
5/16 - 18	36	36	20	20	8	100	
3/8 - 16	45	45	25	25	10	50	
1/2 - 12	53	54	30	30	12	25	
5/8 - 11	62	63	35	35	14	25	
3/4 - 10	71	72	40	40	16	25	
1" - 8	90	90	50	50	20	10	
M6 - 1.0	36	36	20	20	6	100	
M8 - 1.25	36	36	20	20	8	100	
M10 - 1.5	45	45	25	25	10	50	
M12 - 1.75	53	54	30	30	12	25	
M14 - 2.0	62	63	35	35	14	25	
M16 - 2.0	62	63	35	35	14	25	
M20 - 2.5	71	72	40	40	16	25	
M24 - 3.0	90	90	50	50	20	10	
M30 - 3.5	109	108	65	60	24	10	
M36 - 4.0	128	126	75	70	28	10	